

Social Distancing in the Lower Hall

Capacity 19 Candidates and 2 Facilitators

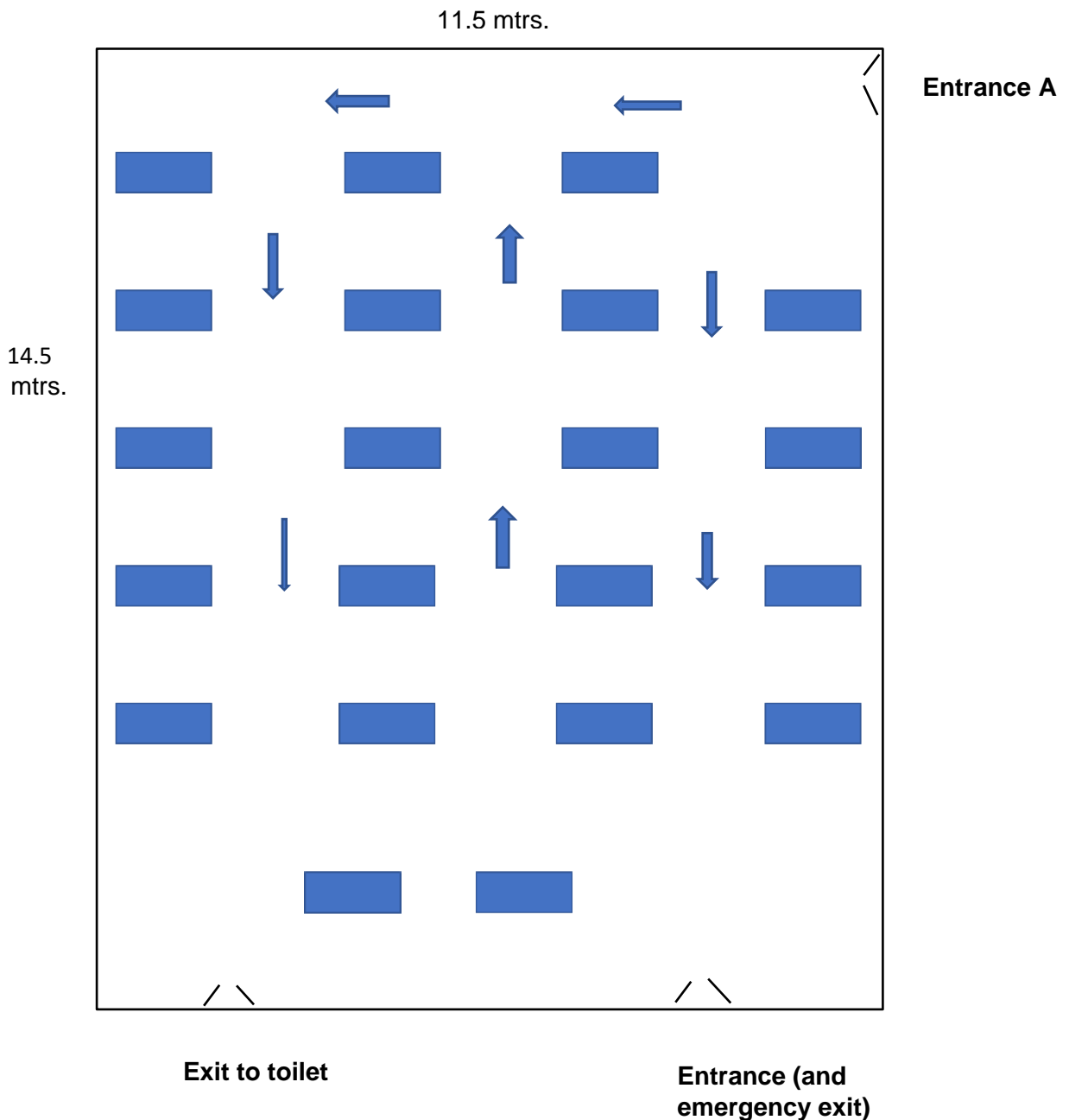

Toilet area

1. All Course attendees arrive via Entrance A
2. All equipment before arrival will be cleaned with Anti Bacteria solutions
3. Anti-Bac cleaning materials will be available for cleaning surfaces when using toilet areas
4. Only one person at a time to use the toilets, please use the signage to indicate occupancy
5. Bring your own mugs for coffee
6. Please follow the guidance that will be clearly visible on the day in respect to pathways
7. Rubber Gloves will be provided on each table so that clients can use the coffee/hot water/milk jugs independently
8. Please respect the 2 metres social distancing when queueing